



# **Teleboom**

For

**Skid Steer Loaders**

**Operator's Manual**  
**Set-Up Assembly and**  
**Parts Information**



**Read this Manual Before Use**

SAFETY	3-4
SERIAL NUMBER/DECAL LOCATION	5-6
USERS INSTRUCTIONS FOR MOUNTING THE HYDRAULIC BOOM	7-8
OPERATING THE TELEBOOM	9
PARTS INFORMATION	10-11
GENERAL SPECIFICATIONS	12
NOTES	13-14
WARRANTY	15

### REFERENCE INFORMATION

Write the correct information for your attachment in the spaces below. Always use these numbers when referring to your attachment.

Serial Number.....

### YOUR ATTACHMENT DEALER

ADDRESS:

PHONE:

CONTACT:

**NOTE:** *Erskine Attachments LLC reserves the right to make improvements in design or changes in specifications at any time without notice and without incurring any obligations to install them on units previously sold.*

# SAFETY

---

**DO NOT** use or perform maintenance on this machine until this manual has been read and understood. In addition, read the Operation and Maintenance Manual(s) pertaining to the attachment and the attachment carrier (“Loader”).

The user is responsible for inspecting the machine daily, and for having parts repaired or replaced when continued use of the machine would cause damage, excessive wear to other parts or make the machine unsafe for continued operation.

If an operating procedure, tool device, maintenance or work method not specifically recommended is used, you must satisfy yourself that it is safe for you and others. You must also ensure that the attachment will not be damaged or made unsafe by the procedures you choose.

Erskine Attachments LLC cannot anticipate every possible circumstance that might involve potential hazard. The safety messages found in this manual and on the machine are therefore not all inclusive.

The signal words **CAUTION**, **WARNING**, or **DANGER** are used to indicate hazards.

**⚠ CAUTION** Indicates a potentially hazardous situation which, if not avoided, may result in minor or moderate injury.

**⚠ WARNING** Indicates a potentially hazardous situation which, if not avoided, could result in death or serious injury.

**⚠ DANGER** Indicates a potentially hazardous situation which, if not avoided, will result in death or serious injury.

The word **IMPORTANT** is used in the text when immediate damage will occur due to improper technique or operation.

The word **NOTE** is used to convey information that is out of context with the manual text; special information such as specifications, techniques, reference information, and other information of a supplementary nature.

## Improper operation can cause serious injury or death.

### Pre-operation

- This attachment is designed for lifting and moving objects. **NEVER** use this machine for any other purpose. **NEVER** exceed the weight limits.
- Read the operator's manual for the "Skid Steer Loader." **NEVER** allow untrained people to operate.
- Loader must have Rated Operating Capacity of 1800 lbs or greater.
- Operating instructions must be given to everyone before operating this attachment and at least once a year thereafter in accordance with OSHA regulations.
- **NEVER** exceed the maximum recommended input power or speed specifications for the attachment. Over-powering or over-speeding the attachment may cause personal injury and/or machine damage.
- Keep all shields, guards, and covers in place.
- Do not modify equipment or add attachments that are not approved by Erskine Attachments LLC.
- Use adequate safety warning lights and devices as required by local regulations. Obey all local laws and regulations regarding machine operation on public property.

### Operation

- Hydraulic connections may be hot after use. Use gloves if connecting or disconnecting after use.
- Check and be sure all operating controls are in neutral before starting the engine.
- **NEVER** lift people.
- To avoid electric shock or electrocution, **NEVER** operate the attachment near overhead power lines.

### Operation (continued)

- Keep people away from loader, attachment, and boom load when in use. This attachment lifts objects and has moving parts. **NEVER** lift load directly over people – load could fall.
- **NEVER** operate near embankments or terrain that is so steep that rollover could occur.
- Always stay in the operator position when using the attachment. If you are using a walk-behind loader, stay behind the loader at the controls while operating.
- Before leaving the operators position, disengage hydraulic drive, lower the attachment to rest flat on the ground, stop engine, set park brake, and wait for all motion to stop.

### Avoid High Pressure Fluids Hazard



- Escaping fluid under pressure can penetrate the skin causing serious injury.
- Avoid the hazard by relieving the pressure before disconnecting hydraulic lines.
- Use a piece of paper or cardboard, NOT BODY PARTS, to check for suspected leaks. Wear protective gloves and safety glasses or goggles when servicing or performing maintenance on hydraulic systems.
- If an accident occurs, see a doctor immediately. Any fluid injected into the skin must be surgically removed within a few hours or gangrene may result.

### Maintenance

- **NEVER** make adjustments, lubricate, clean, or perform any service on the machine while it is in operation.
- Make sure the attachment is serviced on a daily basis. Improper maintenance can cause serious injury or death in addition to damage to the attachment and/or your equipment.

## SERIAL NUMBER AND SAFETY DECAL LOCATIONS

---

### Serial Number Location:

It is important to refer to the serial number of your attachment when making repairs or ordering parts. Early or later models (identification made by serial number) may use different parts, or it may be necessary to use different procedures in doing a specific operation.

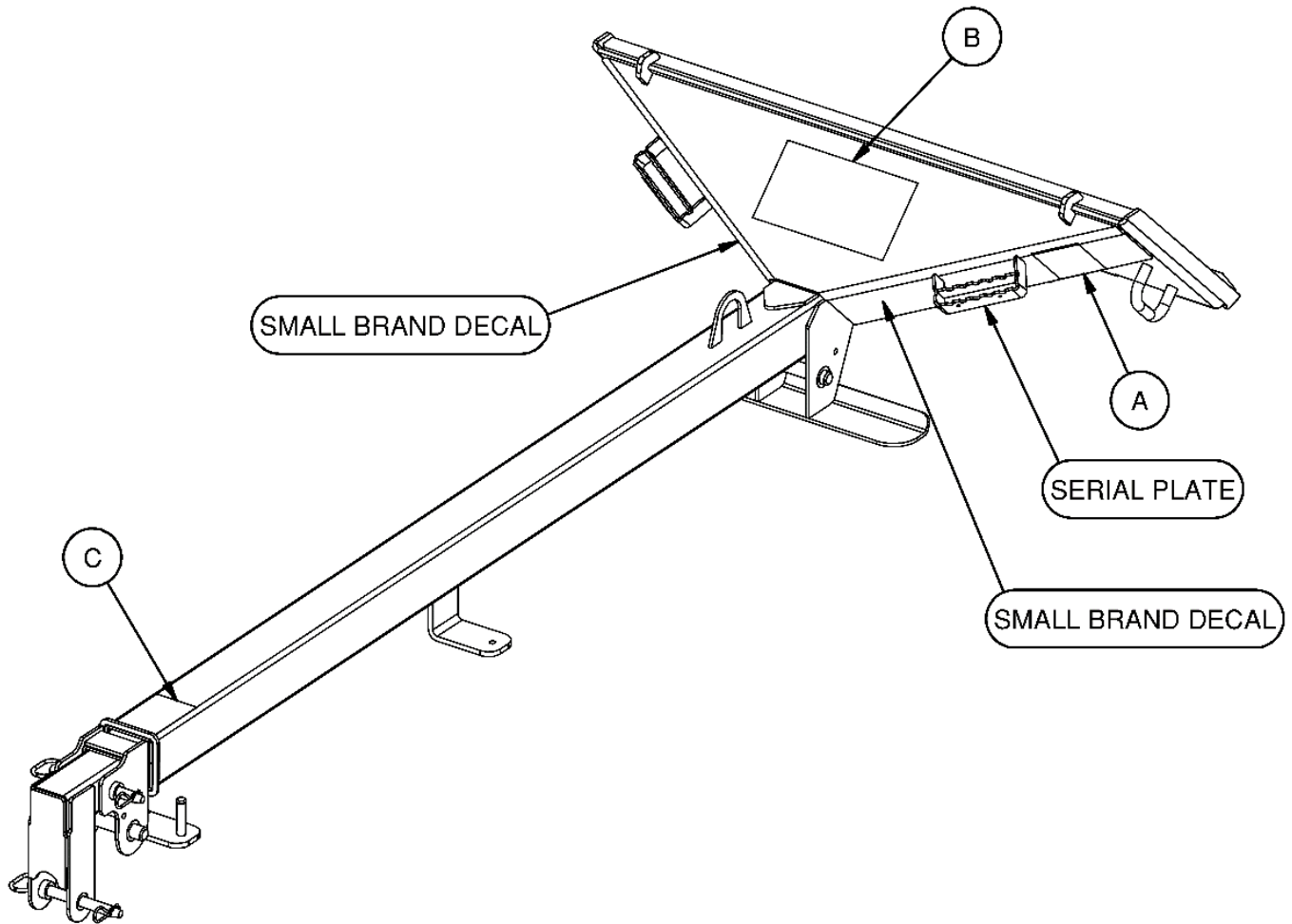

# SERIAL NUMBER AND SAFETY DECAL LOCATIONS

(A)



**Part Number: 200001**

**Location:** On left side of mount plate support

**Quantity: 1**

(B)

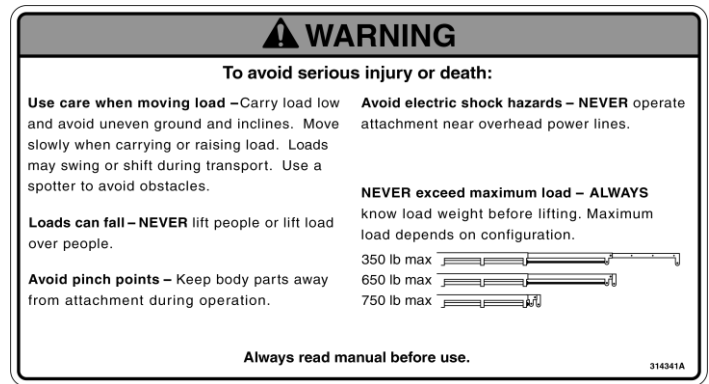

**Part Number: 314341**

**Location:** On top of mount plate support

**Quantity: 1**

(C)



**Part Number: 203234**

**Location:** On top of tube by hook

**Quantity: 1**

## Small Brand Decal

**Location:** On each side of mount plate support near step

**Quantity: 2**

## Safety Decals Locations:

The locations of the safety decals are shown. If these decals are missing, damaged, or painted over they must be replaced. Call Erskine Attachments LLC (218-435-4045) for replacement decals.

## USER'S MOUNTING INSTRUCTIONS

After the initial set-up assembly is completed use the following procedure to mount the attachment to the loader for user operation.

**⚠ WARNING** Coupler wedges or pins must extend through the holes in attachment. Levers must be fully down and locked. Failure to secure wedges or pins can allow attachment to come off and cause injury or death.



1. Use the step, safety treads, and grab handles to get on and off the loader and attachment.

2. Sitting in the operator's seat, lower seat bar and fasten the seat belt.

3. Drive the loader to the rear of the attachment. Put the loader quick attach coupler into the attachment mounting bracket.



4. Tilt the loader coupler backward a small amount until it is fully engaged in the attachment mounting bracket.

5. Stop the engine and engage the park brake.

6. Secure the coupler locking mechanism that attaches the attachment to the loader.



# USER'S MOUNTING INSTRUCTIONS

7. Connect the hydraulic quick couplers from the attachment to the loader.

**IMPORTANT:** Make sure the quick couplers are fully engaged. If the quick couplers do not fully engage, check to see that the couplers are the same size and brand. Do not force the quick couplers together.

**IMPORTANT:** Wipe the ends of the hydraulic quick couplers (both lead and loader) with a rag to remove any possible contamination. Contamination can cause hydraulic components to fail and is not covered under warranty.

**NOTE:** See the loader's operator's manual.

**NOTE:** Attachment is shipped with 8FJX (3/4"-16 UNF Female JIC Swivel) fittings on the ends of the lead hoses.

8. Make sure the hoses are properly routed to fit your specific loader. If the hoses are not routed correctly, hoses may get pinched or rub on tires. Be sure to check the hose routing through the full range of intended motion of the attachment before operating it.

More than one routing may be acceptable depending on the loader. Pick the routing that best suits your loader.

**IMPORTANT:** Proper hose routing is the responsibility of the owner and/or operator. Pinched or stretched hoses are not covered under warranty.

Mounting is now complete and you are ready to use the attachment. Use reverse order of above instructions to dismount the attachment from the loader.

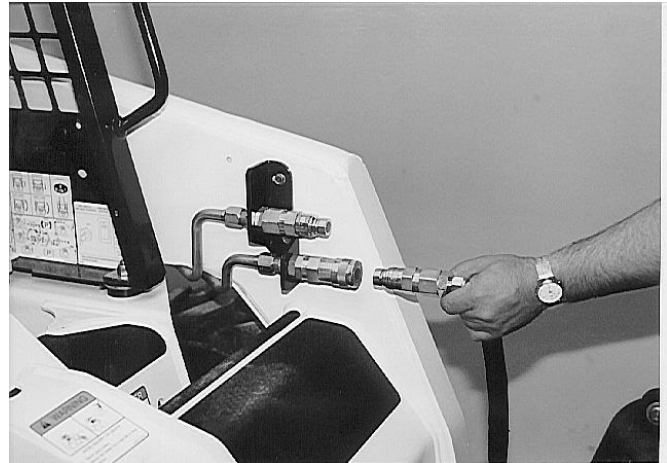



# OPERATING INSTRUCTIONS

**⚠ WARNING** To avoid tipping, NEVER exceed maximum load. ALWAYS know load weight before lifting. Maximum load depends on configuration:

## Rated load of attachment:

- Full retraction: 750 lbs.
- Cylinder extended only: 650 lbs.
- Full extension: 350 lbs.



1. With the operator in the loader seat, seat belt fastened and seat bar lowered (if so equipped), start the engine.

**⚠ WARNING** To avoid injury or death, do not allow any person to be directly under the attachment or load at any time.

**⚠ WARNING** To avoid injury or death, never use Teleboom on an incline to prevent the loader from tipping over.

**⚠ WARNING** To avoid injury or death, carry the load as low as possible when moving the Teleboom.



2. Adjust the manual beam as needed on the ground and before you hook up to what will be hoisted.
3. Make sure the hair pin keeper is installed on both the manual beam pin and lift hook pin before operation.
4. Carry load low and close to the loader while moving the load into position.
5. When the loader is in position to raise the material, do so slowly and carefully.
6. Use the loader's lift arms first and then the attachment cylinder for hoisting to the final desired position.

**⚠ WARNING** To avoid injury or death, be aware of your surroundings. Contact with electrical power lines can be fatal. Always use a spotter to help guide you when moving or lifting.



## PARTS INFORMATION

REF.	PART NO.	DESCRIPTION	2ND DESCRIPTION	QTY.
1	314301	MOUNT TUBE		1
2	314302	MIDDLE TUBE		1
3	314303	INNER TUBE		1
4	316026	PIN 1 X 5		2
5	314327	CYLINDER 2.50 X 72 TIE ROD	RED OR BLACK	1
6	314326	TUBE CYLINDER KEEPER		1
7:1	300231	ADPT STR 6MP-6MJ	IF RED CYLINDER	1
7:1	201925	ADPT STR 8MB-6MJ	IF BLACK CYLINDER	1
7:2	314334	ADPT STR 6MP-6MJ ORFICE	IF RED CYLINDER	1
7:2	314338	ADPT STR 8MB-6MJ ORFICE	IF BLACK CYLINDER	1
7:3	314335	HOSE 3/8 X 82 8FJX-6FJX-90		1
7:4	314336	HOSE 3/8 X 159 8FJX-6FJX-90		1
8	320235	PIN HITCH 3/4 X 6		2
9	103116	BOLT HEX	3/8 X 1 - UNC - GR 5	2
10	37212	NUT HEX	3/8 - UNC - GR 5 - REV LOCK	3
11	13116	BOLT HEX	3/8 X 3.25 - UNC - GR 5	1
12	104410	PIN CLIP #9 5/32 X 3-1/16		2

## PARTS INFORMATION

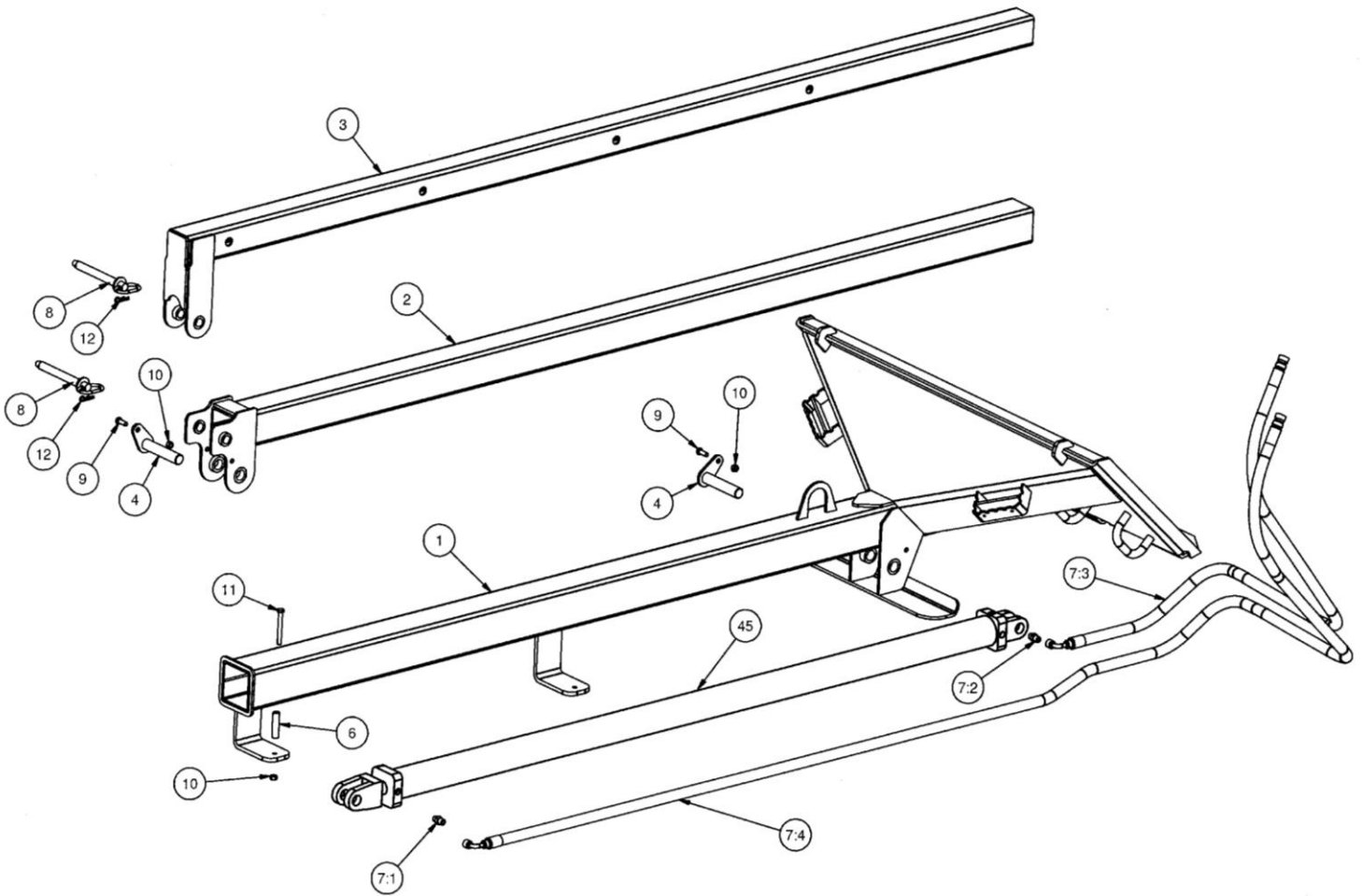

## GENERAL SPECIFICATIONS

Model	HB 18
Hydraulic Cylinder	2.5" Bore, 72" Stroke
Length Fully Extended	256"
Rated Load Fully Extended (horizontal)	350 lbs.
Rated Load Fully Contracted (horizontal)	750 lbs.
Rated Load Fully Contracted @ 75°	1000 lbs.
ROC of Skid Steer	1800 lbs. minimum
Operating Weight	450 lbs.

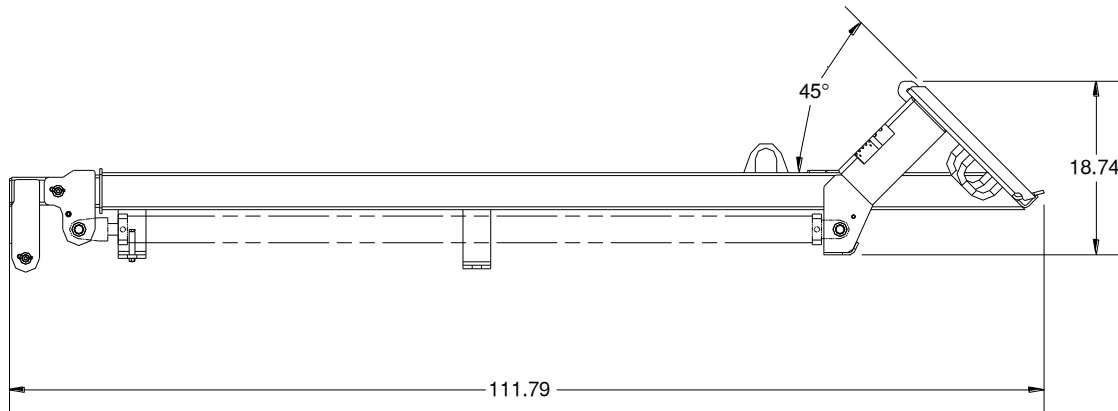
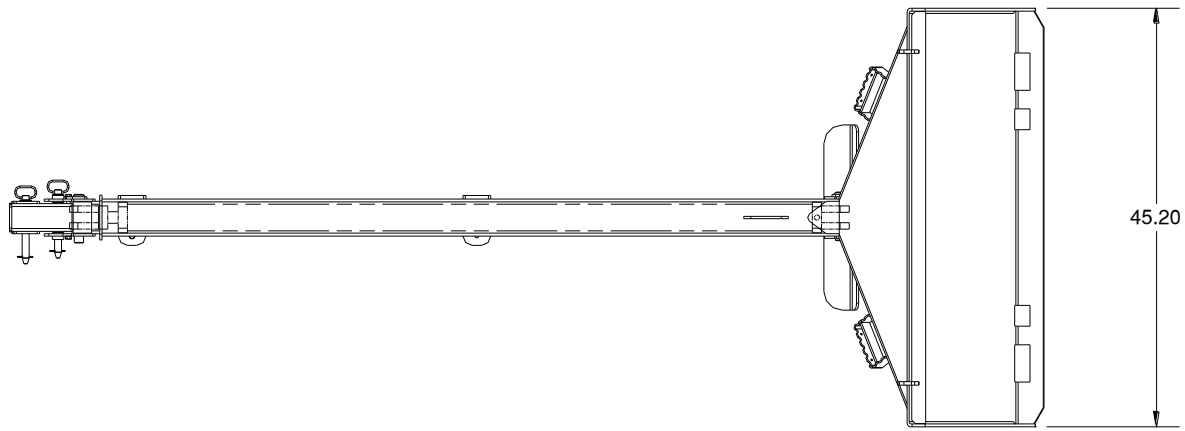

All dimensions are in INCHES.

## NOTES

This image shows a single sheet of white paper with horizontal ruling lines. The lines are evenly spaced and run across the width of the page. There are no margins, text, or other markings on the paper.

[illegible]



## **LIMITED WARRANTY**

Erskine Attachments, LLC warrants each new machine manufactured by us to be free from defects in material and workmanship for a period of twenty-four (24) months from date of delivery to the original purchaser.

Our obligation under this warranty is to replace free of charge, at our factory or authorized dealership, any part proven defective within the stated warranty time limit.

All parts must be returned freight prepaid and adequately packaged to prevent damage in transit.

This warranty does not cover:

1. New products which have been operated in excess of rated capacities or negligence
2. Misuse, abuse, accidents or damage due to improperly routed hoses
3. Machines which have been altered, modified or repaired in any manner not authorized by our company
4. Previously owned equipment
5. Any ground engaging tools in which natural wear is involved, i.e. tooth tips, cutting teeth, etc
6. Normal maintenance
7. Fork tines
8. Hydraulic motors that have been disassembled in any manner

In no event will the Sales Representative, Dealership, Erskine Attachments, LLC, or any other company affiliated with it or them be liable for incidental or consequential damages or injuries, including but not limited to the loss of profit, rental or substitute equipment or other commercial loss. Purchaser's sole and exclusive remedy being as provided here in above.

Erskine Attachments, LLC must receive immediate notification of defect and no allowance will be made for repairs without our consent or approval.

This warranty is in lieu of all other warranties, express or implied by law or otherwise, and there is no warranty of merchantability or fitness purpose.

No agent, employee, or representative of Erskine Attachments, LLC has any authority to bind Erskine Attachments, LLC to any warranty except as specifically set forth herein. Any of these limitations excluded by local law shall be deemed deleted from this warranty; all other terms apply.

This warranty may not be enlarged or modified in any manner except in writing signed by an executive officer of Erskine Attachments, LLC to improve its products whenever it is possible and practical to do so. Erskine Attachments, LLC reserves the right to make changes and or add improvements at any time without incurring any obligation to make such changes or add such improvements to products previously sold.

Erskine Attachments, LLC  
P.O. Box 1083 Alexandria, MN 56308  
Phone (218) 435-4045



**P/N 314349      Date Printed: 4/11/2022**  
Erskine Attachments LLC

Printed in U.S.A.